

## All Weather Speaker

### MAIN APPLICATIONS

- Convention centers
- Athletic fields
- Stadiums
- Theme parks
- Swimming pools
- Cruise ships
- Malls
- Ballrooms
- Outdoor background music

### MAIN FEATURES

- 2-way configuration
- Rotomoulded enclosure in polypropylene
- 5" cone and 1" dome for high frequencies
- 100V line transformer
- 4 wires cable to select the power tapping
- IP55 weather resistant
- Standard black color



**EN 54-24:2008**

**CERTIFICATE OF COSTANCY OF  
PERFORMANCE - TYPE B**  
nr. 0068/CPR/067-2019

**IP55**

**ATTESTATION OF CONFORMITY**  
nr. CPR/181446\_1-1-2019  
EN 60529:1991-10

*Declaration of Performance (DoP) available on the website [www.fbt.it](http://www.fbt.it)*

### DESCRIPTION

The FBT SHADOW 105T - EN is a weatherproof two way loudspeaker system offering substantial power and efficiency for a variety of professional indoor or outdoor applications. The low frequency transducer is a 5" woofer with a 1" voice coil. The high frequency section is a 1" dome tweeter with 100° x 70° coverage. The FBT SHADOW 105T - EN features a standard 100V line transformer with selectable power tapping. The cabinet is a single piece rotational moulded in polypropylene, fully UV protected. The FBT SHADOW 105T - EN is internal equipped with ceramic terminal block and thermal fuses ensuring the continued operation of loudspeakers in the event of a fire; in addition all connections use flame-retardant cabling which adheres to the EN50200 standard (with IP68 airtight cable glands). The cabinet is equipped with a die-cast aluminum wall bracket with ball-socket for multi angle adjustment capability with a security cable. The grille is in custom perforated stainless steel with 3 layers of protection. The FBT SHADOW 105T - EN meets the requirements of IP55 code (International Protection Rating).

### TECHNICAL SPECIFICATIONS

#### GENERAL

Configuration	way	2
Low frequency woofer	inch	1 x 5 - 1 coil
High frequency driver	inch	1 x 1 dome

#### ACOUSTIC SPEC.

Frequency response	(@-6dB)	100Hz - 18kHz
Crossover frequency	kHz	3
Sensitivity (@1W,1m)	dB	87.5
MAX SPL (cont/peak)	dB	104 / 92
Dispersion horizontal (-6dB)	500Hz	180°
	1kHz	140°
	2kHz	80°
	4kHz	95°
Dispersion vertical (-6dB)	500Hz	160°
	1kHz	110°
	2kHz	70°
	4kHz	40°
Recommended HP filter	Hz - dB oct.	80 - 24

#### INPUTS & OUTPUTS

Connectors		4 wire cable
------------	--	--------------

#### AMPLIFIER

Recommended amplifier	W RMS	100
Transformer	V / W	100 / 50
Rated noise power 100hrs (voltage)	W (V)	50 (20)
Short term power (IEC 268-5)	W	200
Nominal impedance 100V line	Ohm (W)	200 (50) 400 (25)
Operating / storage temperature	°C	-25 to +55 / -40 to +70
Relative umidity		<95%

#### MECHANICAL SPEC.

Material		Polystyrene
Net dimensions (WxHxD)	mm	168 x 222 x 161
	inch	6.61 x 8.74 x 6.33
Transport dimensions (WxHxD)	mm	250 x 270 x 220
	inch	9.84 x 10.62 x 8.66
Net weight	kg	3.1
	lb	6.83
Transport weight	kg	3.6
	lb	7.93

## HORIZONTAL POLAR DIAGRAM

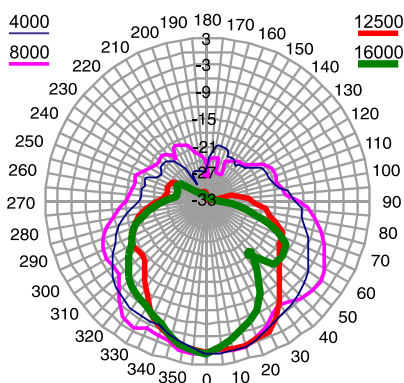
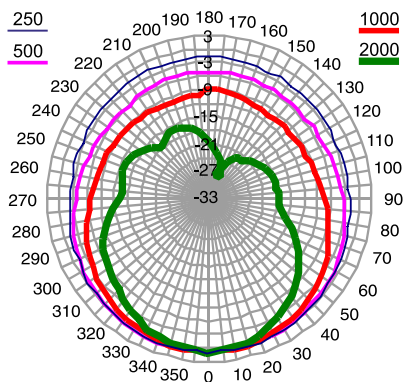

## VERTICAL POLAR DIAGRAM

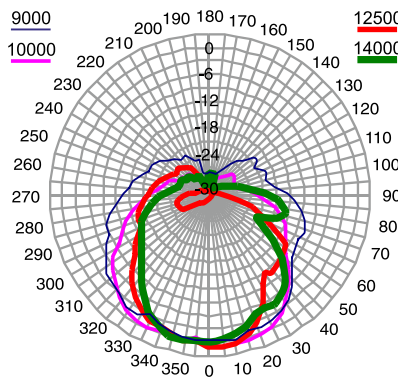
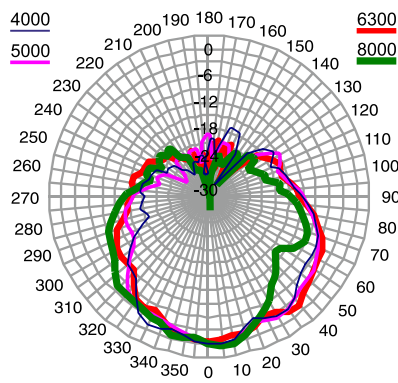
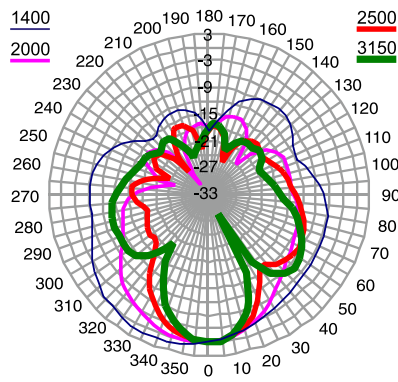
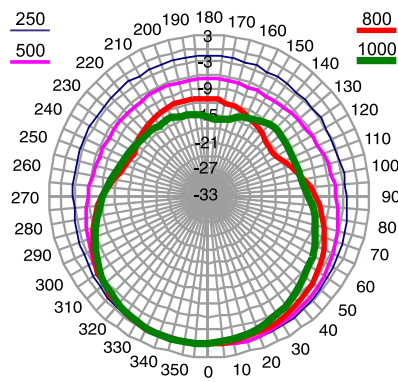

## FREQUENCY RESPONSE DIAGRAM

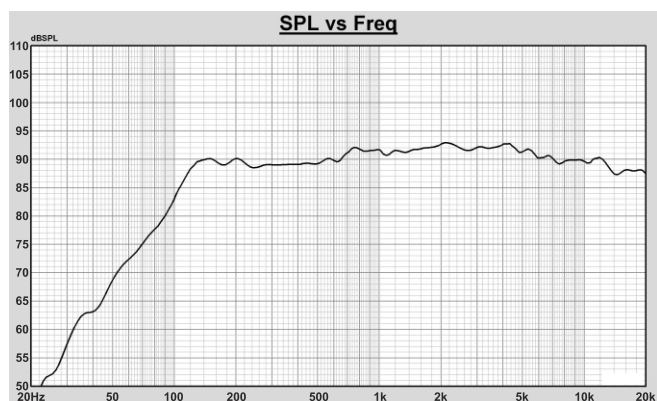

## DIMENSIONAL DRAWING

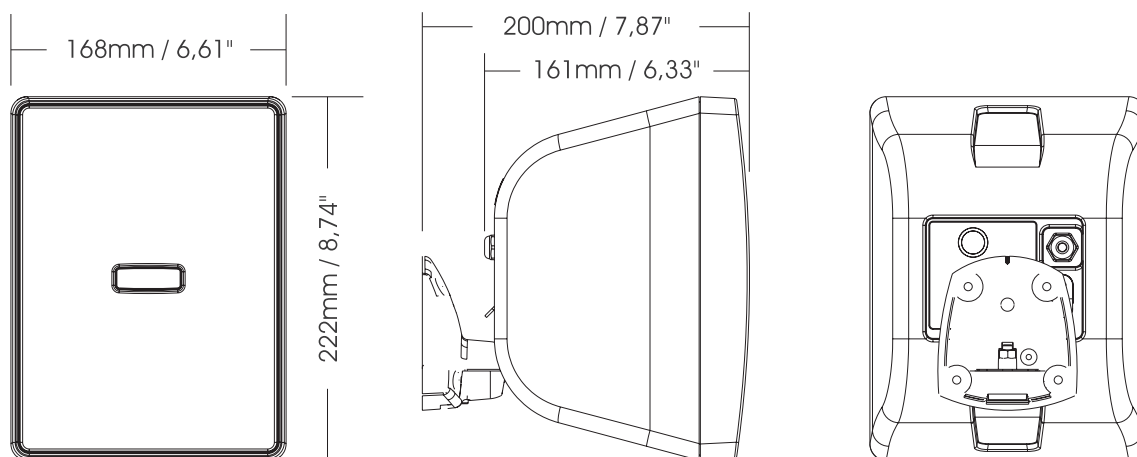

## INSTALLATION

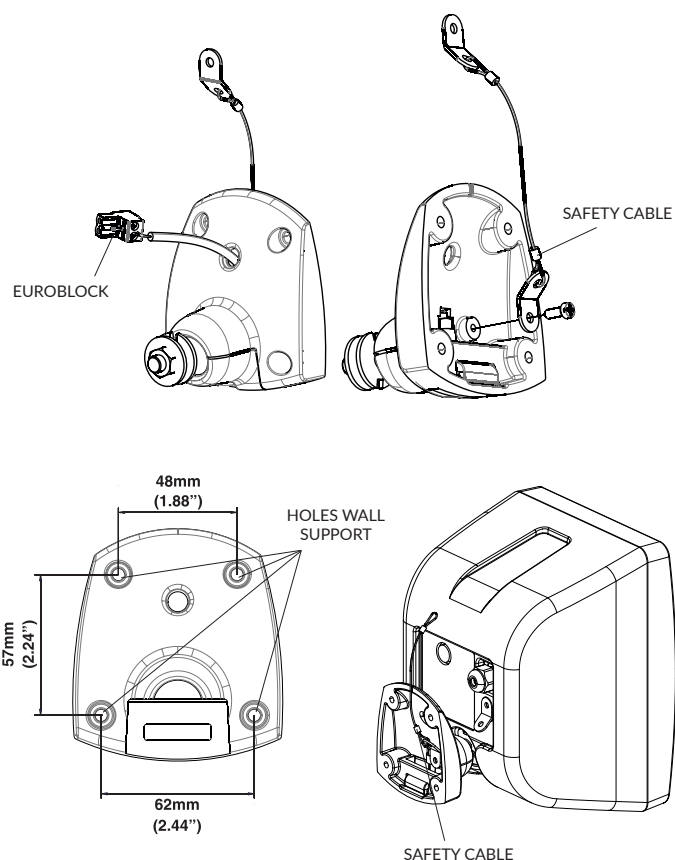

## LOUDSPEAKERS PHYSICAL REFERENCES

