

# All Weather Speaker

## MAIN APPLICATIONS

- Convention centers
- Athletic fields
- Stadiums
- Theme parks
- Swimming pools
- Cruise ships
- Malls
- Ballrooms
- Outdoor background music

## MAIN FEATURES

- 2-way multipurpose 8" coax
- Sturdy molded polypropylene curved enclosure
- 8" coaxial woofer with 2" coil
- 1" HF driver with 1.4" coil
- 100V line transformer with selectable 100-50W
- 4 wires cable to select the power tapping
- IP55 weather resistant
- Completely manufactured in Italy

**EN 54-24:2008**

**CERTIFICATE OF COSTANCY OF  
PERFORMANCE - TYPE B**  
nr. 0068/CPR/011-2019

**IP55**

**ATTESTATION OF CONFORMITY**  
nr. CPR/181446\_1-1-2019  
EN 60529:1991-10

*Declaration of Performance (DoP) available on the website [www.fbt.it](http://www.fbt.it)*

## DESCRIPTION

The FBT SHADOW 108CT/EN is a weatherproof coaxial two way loudspeaker system offering substantial power and efficiency for a variety of professional indoor or outdoor applications. The low frequency transducer is a 8" woofer with a 2" voice coil. The high frequency section is a 1" driver with 1.4" voice coil on conical 90° horn. The FBT SHADOW 108CT/EN features a standard 100V line transformer. The cabinet is a single piece rotational moulded in polyethylene, fully UV protected. The FBT SHADOW 108CT/EN is internal equipped with ceramic terminal block and thermal fuses ensuring the continued operation of loudspeakers in the event of a fire; in addition all connections use flame-retardant cabling which adheres to the EN50200 standard (with IP68 airtight cable glands). The cabinet is equipped with a stainless steel U-bracket. The grille is in custom perforated stainless steel with 3 layers of protection. The FBT SHADOW 108CT/EN meets the requirements of IP55 code (International Protection Rating).

## TECHNICAL SPECIFICATIONS

### GENERAL

Configuration	way	2
Low frequency woofer	inch	8 - 2 coil
High frequency driver	inch	1 - 1.4 coil

### ACOUSTIC SPEC.

Frequency response	(@-6dB)	94Hz - 20kHz
Crossover frequency	kHz	1.8kHz
Sensitivity (@1W,1m)	dB	94
MAX SPL (1mt / 4mt)	dB	115 / 103
Dispersion horizontal (-6dB)	500Hz	160°
	1kHz	100°
	2kHz	90°
	4kHz	80°
Dispersion vertical (-6dB)	500Hz	160°
	1kHz	100°
	2kHz	90°
	4kHz	80°
Recommended HP filter	Hz - dB oct.	70 - 24

### INPUTS & OUTPUTS

Connectors	4 wire cable
------------	--------------

### AMPLIFIER

Recommended amplifier	W RMS	300
Transformer	V / W	100 / 120 - 60
Rated noise power 100hrs (voltage)	W (V)	150 (33.5)
Short term power (IEC 268-5)	W	600
Nominal impedance 100V line	Ohm (W)	85 (120)
	Ohm (W)	166 (60)
Nominal impedance	Ohm	8
Operating / storage temperature	°C	-25 to +55 / -40 to +70
Relative umidity		<95%

### MECHANICAL SPEC.

Code		41808
Material		Polyethylene rotomolded
Net dimensions (WxHxD)	mm	285 x 285 x 250
	inch	11.22 x 11.22 x 9.84
Transport dimensions (WxHxD)	mm	390 x 390 x 340
	inch	15.55 x 15.35 x 13.39
Net weight	kg / lb	10.50 / 23.14
Transport weight	kg / lb	11.80 / 26.01

DIMENSIONAL DRAWING

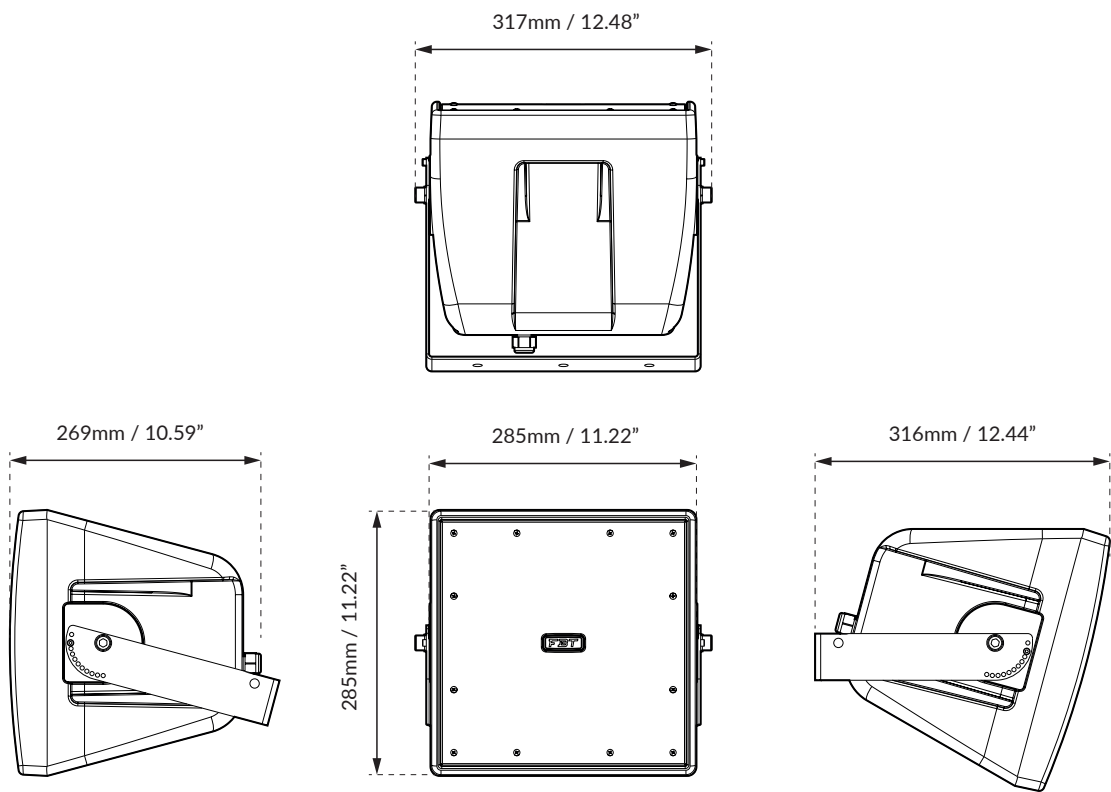

INCLUDED ACCESSORY

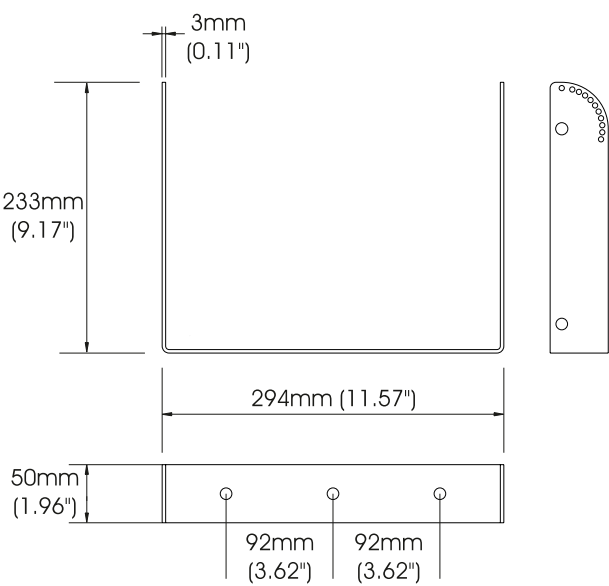

LOUDSPEAKERS PHYSICAL REFERENCES

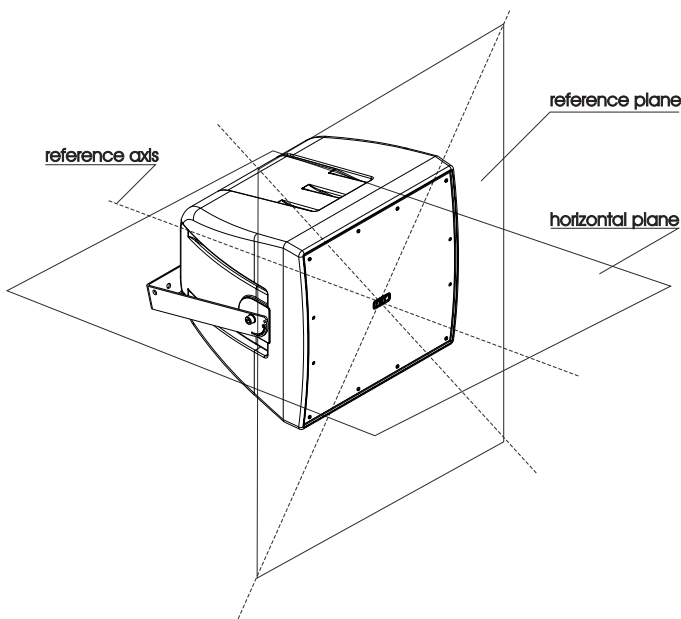

HORIZONTAL POLAR DIAGRAM

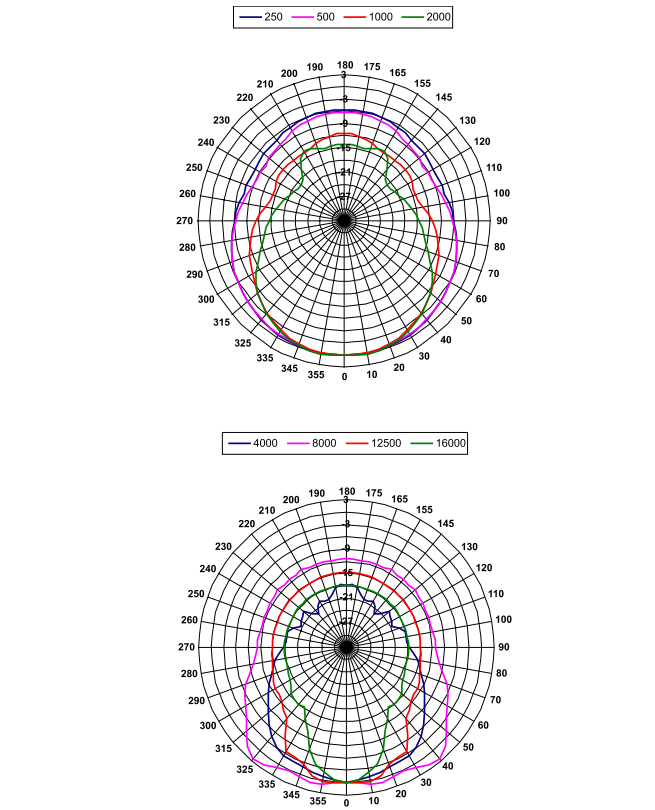

VERTICAL POLAR DIAGRAM

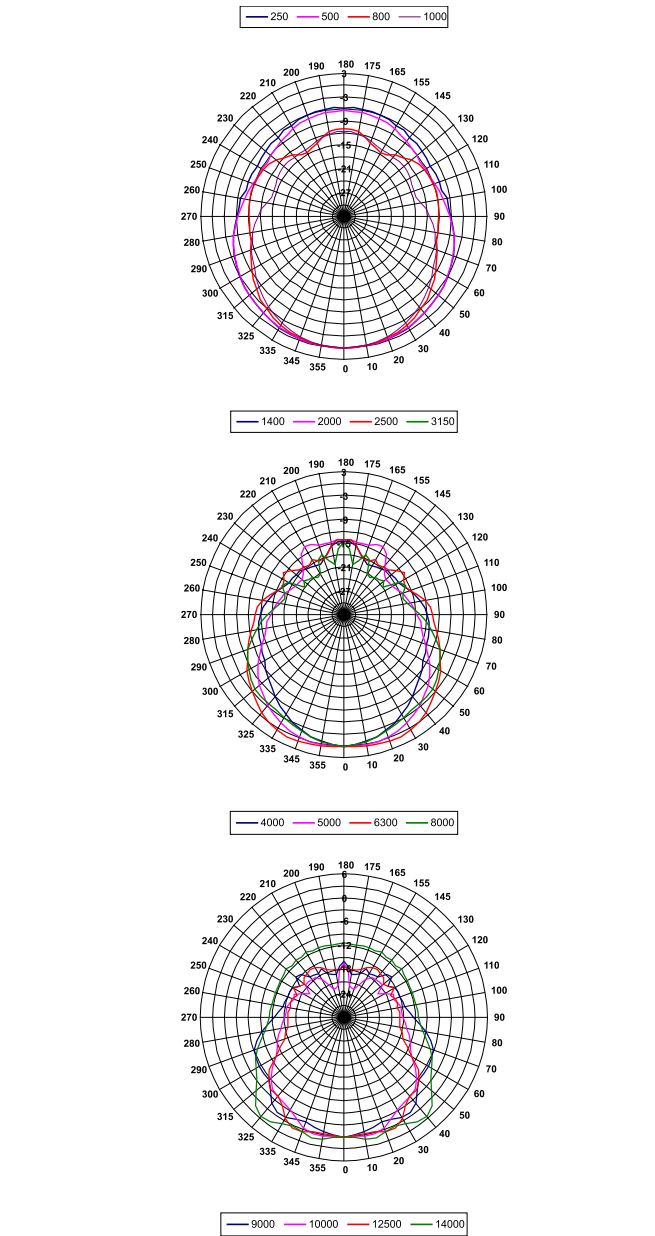

FREQUENCY RESPONSE DIAGRAM

