

Precision Coverage Vertical Array

MAIN APPLICATIONS

- Permanent installations in:
- Theatres, Concert Halls, Clubs,
 - Places of Worship, Conference Rooms, Indoor Sports, Arenas & Stadiums
- Sound reinforcement for live events:
- Touring, Bands, Orchestras

MAIN FEATURES

- Compact 2-way line array system in bass reflex
- 2 x 10" woofers with 2.5" coil
- 2 x custom B&C HF compression drivers with 1" throats
- Frequency response (@-6dB) from 55Hz-20kHz
- Class D amplifiers: 800W RMS LF, 400W RMS HF with switching power supply
- MAX SPL capability: 136dB
- Integrated rigging hardware
- 0.59" Birch plywood cabinet
- Front led identification Hi-power led
- Completely Manufactured in Italy



DESCRIPTION

A true line array system encompassing advanced technology and refined Italian engineering, these are the principles behind MUSE, a new sound reinforcement solution from FBT that redefines the modern line array in terms of power, size, light weight, flexibility and ease of use. The MUSE 210L is the ideal choice when line array performance is needed and a fast and easy set up is a must. The modularity of the FBT MUSE 210L makes it extremely flexible for a wide range of applications, from a small two cabinets PA system to an elaborate line array system consisting of up to 16 FBT MUSE 210L cabinets along with multiple FBT MUSE 218 subs for large concert events. The system features 2 x 10" woofers with 2.5" voice coil and two custom B&C HF compression drivers with 1" throats. The FBT MUSE 210L shall meet the following performance criteria: Frequency Response of 60Hz to 18kHz, Frequency Sensitivity of 101dB for LF / 112dB for HF, MAX SPL of 135dB, Recommended Power Amplifier 800W RMS LF and 200W RMS HF. The system not include an internal passive crossover. The FBT MUSE 210L cabinets coupling hardware is internally integrated and allows the suspension of 16 arrays with a splay angle between 0° - 10° with 1° step. FBT MUSE 210L cabinets are constructed from 0,59" (15mm) birch plywood, and incorporate two die cast aluminium handles; the front is protected by a heavy duty metal grille with anti-resonance spacers and exclusive synthetic cloth to protect the drivers. The FBT MUSE 210L provides a wide range of hardware accessories for flying and ground stacked configurations.

TECHNICAL SPECIFICATIONS

GENERAL

Code		39457
Configuration	way	2 passive reflex line array module
Low frequency woofer	inch	2 x 10 - 2.5 coil
High frequency driver	inch	2 x 1 - 1.7 coil

ACOUSTIC SPECIFICATIONS

Frequency response (@-6dB)	Hz	60 - 18k
Sensitivity (@1W/1m)	dB	101 (LF) / 112 (HF)
MAX SPL (cont/peak)	dB	128 / 135
Dispersion	H° x V°	90 x 10 - dependant upon the number of elements
Recommended HP filter	Hz - dB oct	32 - 24
Recommended external filter	Hz	Digital management with preset

INPUTS & OUTPUTS

Input connectors		2 x Speakon NL4M IN/OUT
------------------	--	-------------------------

AMPLIFIER

Recommended amplifier	W RMS	800 (LF) / 200 (HF)
Long term power	W	400 (LF) / 100 (HF)
Short term power (IEC 268-5)	W	1600 (LF) / 400 (HF)
Nominal impedance	Ohm	16 (LF) / 32 (HF)

MECHANICAL SPECIFICATIONS

Material		0.59" Birch plywood
Net dimensions (WxHxD)	mm	652 x 296 x 425
	inch	25.66 x 11.65 x 16.73
Transport dimensions (WxHxD)	mm	530 x 810 x 390
	inch	20.87 x 31.89 x 15.35
Net weight	kg	37.80
	lb	83.33
Transport weight	kg	39.70
	lb	87.52

DIMENSIONAL DRAWINGS

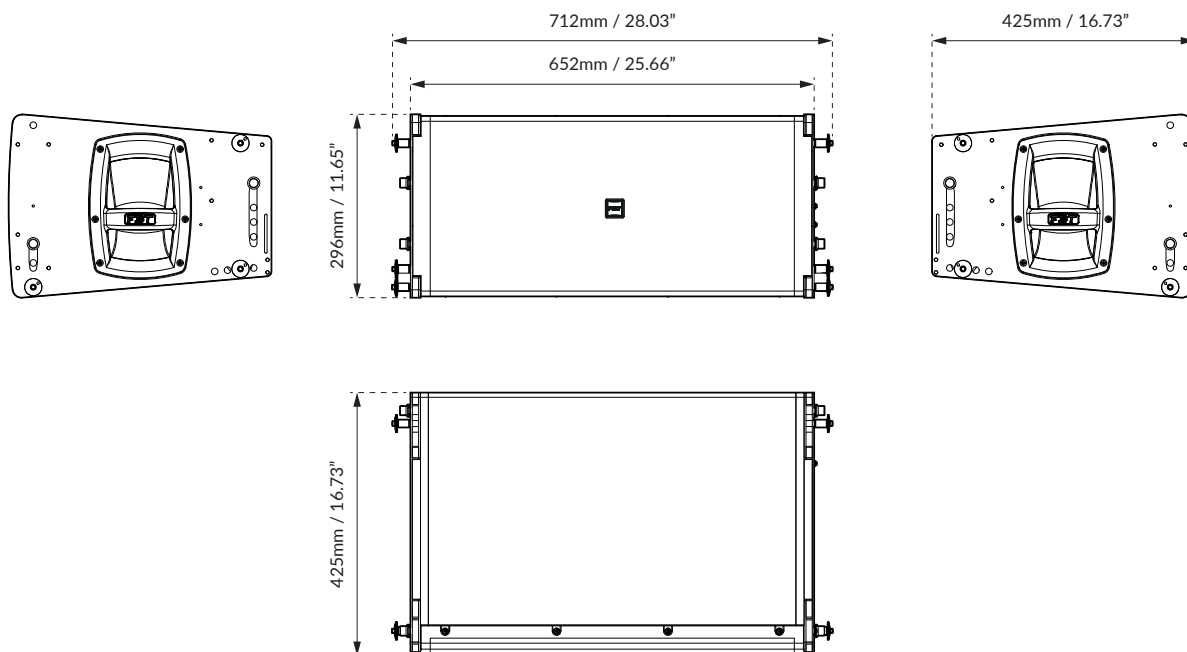

ACCESSORIES

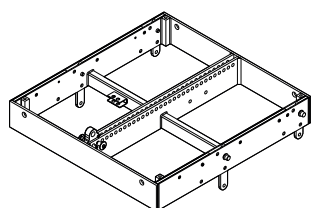

MS-F 210

Flying Bar

Code: 38834

686 x 100 x 652mm
27 x 3.93 x 25.66inch
30 kg / 66.13 lb

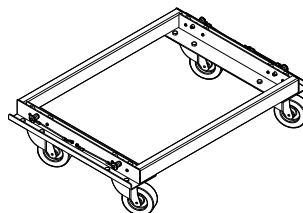

MS-T 210

Trolley with Wheels

Code: 38886

722 x 182 x 500mm
28.42 x 7.18 x 19.68inch
14 kg / 30.86 lb

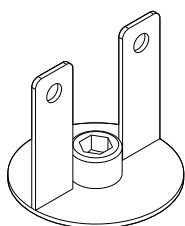

MS-J 210

Metal Joint

Code: 39401

ø100 x 92mm
ø3.93 x 3.62inch
0.50 kg / 1.10 lb

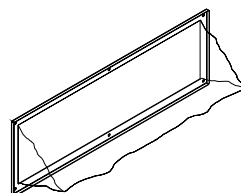

MS-C 210

Rain Cover

Code: 39437

0.50 kg / 1.10 lb

CONTROL PANEL



1. Speakon connectors are connected in parallel mode. One connector can be used to connect the box to the output of a power amplifier, the other to connect to a second box.

MUSE210L is a bi-amplified 2-way system, that is, it needs to be driven by two amplification channels, one for the LF section and one for the HF section. Internally there is a protection on the HF channel that eliminates low frequencies in case of connection error, but there is no passive crossover. Nominal impedances are 16 Ohm for LF and 32 Ohm for HF. In the rear dashboard there are two Neutrik Speakon NL4M connectors with the 4 pins connected in parallel to each other. In this way it is possible to link two or more speakers by connecting them in cascade with a 4-conductor cable. MUSE210L is a very complex acoustic system and needs to be driven by processed amplifiers (with DSP on board) configured with presets created specifically by FBT. The use of the MUSE system with presets not validated by FBT or even without any specific preset, in addition to not guaranteeing adequate performance, puts the reliability of the internal components at risk and is therefore absolutely prohibited. Unprocessed amplifiers can also be used, but connected upstream with a Digital Loudspeaker Processor with a preset authorized by FBT which guarantees correct alignment, equalization and protection of the system.

	LF+	LF-	HF+	HF-
SPEAKON NL4M INPUT	1+	1-	2+	2-
SPEAKON NL4M OUTPUT/LINK	1+	1-	2+	2-

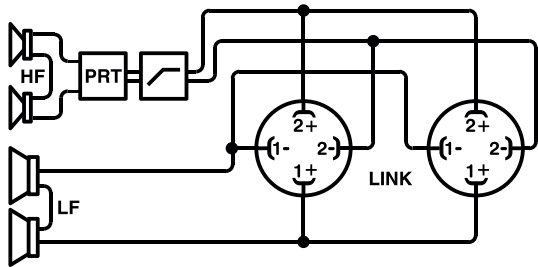

Link of two or more speakers

Attention! In this configuration it is necessary to choose an amplifier capable of driving a load resulting from the parallel of the speakers connected both in the LF and HF way. The section of the SPEAKON cable must be suitable for the current supplied to the speakers. We generally recommend using the following sections:

- 4 wires x 2.5mm² length up to 20mt
- 4 wires x 4mm² over 20 meters