

Processed Active Subwoofer

MAIN APPLICATIONS

- Permanent installations in:
Theatres, Concert Halls, Clubs, Places of Worship, Conference Rooms, Indoor Sports, Arenas & Stadiums
- Sound reinforcement for live events:
Touring, Bands, Orchestras

MAIN FEATURES

- 18mm / 0.70" birch plywood enclosure
- 1200W RMS class D amplifier
- 2 x 460mm/18" custom made for FBT by B&C woofers
- with 75mm/3" coil
- Frequency response 30Hz - 120Hzc
- Control panel with stereo XLR in & out, volume, preset, delay, phase, 3 status led indicators
- SPL capability 140dB
- DSP with 6 presets
- 2 x M20 threads for stand pole mount
- Completely Manufactured in Italy



DESCRIPTION

The FBT SUBline 218SA, 2 x 18" bass reflex design subwoofer, is the perfect low-frequency extension and the ideal companion for the FBT MUSE 210LA line array or ground stack applications with optional metal base. The FBT SUBline 218SA shall meet the following performance criteria: Frequency response of 30Hz to 120Hz, Maximum SPL of 140dB peak, Class D amplifier 1200W RMS. The FBT SUBline 218SA provides a DSP with 6 presets-cardioid and infra configurations. The FBT SUBline 218SA feature 0.70" Baltic birch plywood construction covered in a scratch resistant black paint with 2 x M20 top-mounted stand adapter and four FBT design aluminium handles. The control panel provides stereo XLR in & out, volume control, preset, delay, phase 0°-180°, 3 status led indicators.

TECHNICAL SPECIFICATIONS

GENERAL

Configuration	way	1 reflex
Low frequency woofer	inch	2 x 18 - 3 coil

ACOUSTIC SPEC.

Frequency response	(@-6dB)	30Hz - 100Hz
Crossover frequency	Hz	100
MAX SPL (cont/peak)	dB	137 / 140 half space
Dispersion	H x V	Omnidirectional

POWER SUPPLY

Power cord	mt ft	7 22.96
AC power requirement	W	1050

INPUTS & OUTPUTS

Input connectors		XLR IN/OUT
------------------	--	------------

AMPLIFIER

Built-in amplifier MAX	W RMS	1200
Built-in amplifier MAX peak	W	2400
Input impedance	kOhm	22

MECHANICAL SPEC.

Material		Birch plywood
Net dimensions (WxHxD)	mm inch	975 x 661 x 670 38.39 x 26.02 x 26.38
Transport dimensions (WxHxD) with pallet	mm inch	1150 x 830 x 800 45.28 x 32.68 x 31.50
Net weight	kg lb	83.50 184.08
Transport weight with pallet	kg lb	96.50 212.74

DIMENSIONAL DRAWINGS

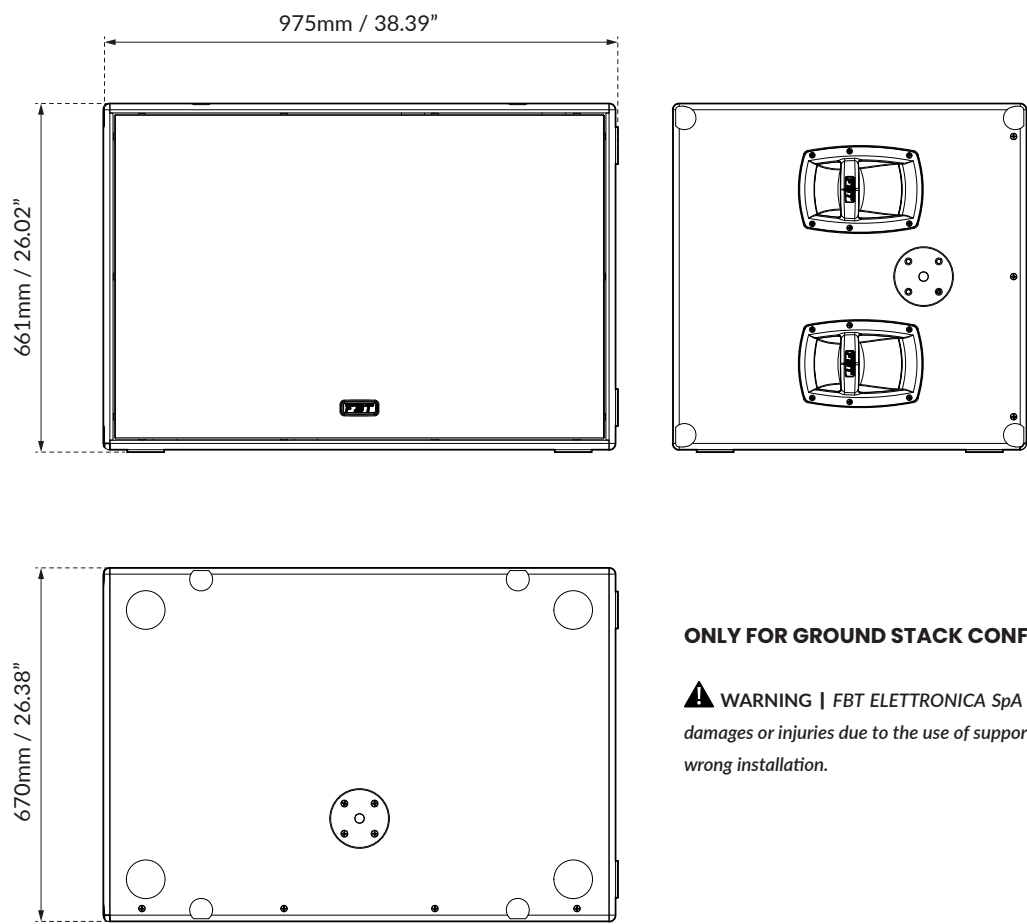

ONLY FOR GROUND STACK CONFIGURATION

⚠ WARNING | FBT ELETTRONICA SpA accepts no responsibilities for any possible damages or injuries due to the use of supports or structures not strong enough or due to wrong installation.

FREQUENCY RESPONSE DIAGRAM

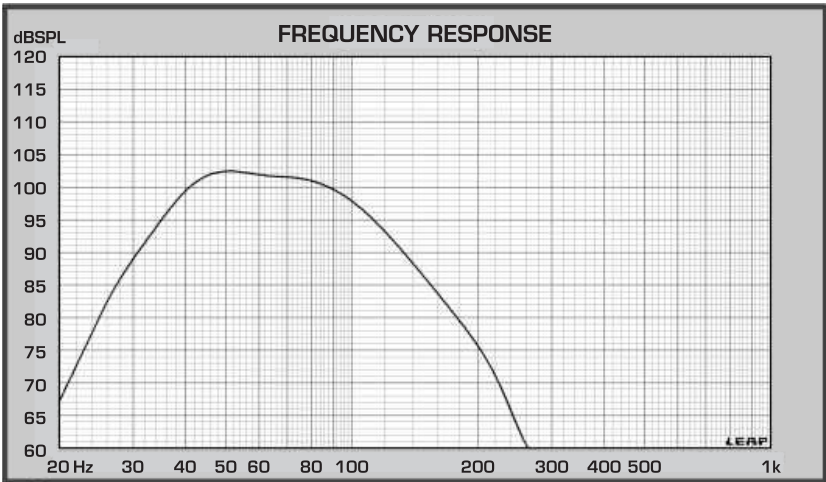

CONTROL PANEL

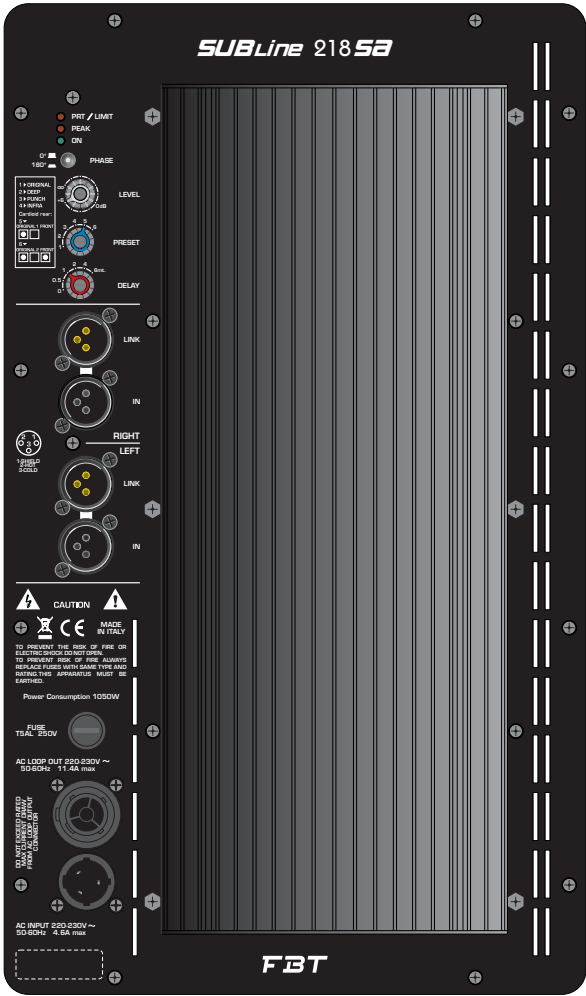

ACCESSORIES

SL-C 218S

Nylon cover

SL-CH 218S

Nylon cover with wheels

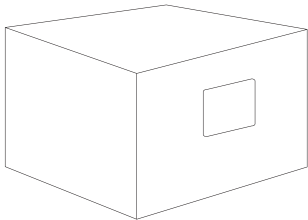

KBW-1004S

4 x wheels kit - 2 with brake

Sheet steel

ø100mm
ø3.93inch
4 kg / 2.20 lb

