

# Sound Reinforcement Subwoofer

## MAIN APPLICATIONS

- School and corporate audio visual sound reinforcement
- Background music/announcement: restaurants, pubs
- Transportation terminals, clubs, auditorium, theatres, gyms, houses of worship
- Suitable for low frequency extension and reinforcement of the CLA 406A array, especially for live performance

## MAIN FEATURES

- Active subwoofer in bass-reflex design
- 0,59" birch plywood enclosure
- 1 x 18" B&C high excursion woofer with 3" voice coil
- 1200W RMS Class D power amplifier with switch mode power supply
- DSP processor with 8 presets
- Neutrik Powercon Cable Duplex power supply connectors
- M20 (0,78") top mount speaker stand socket
- Two diecast aluminium carrying handles
- Completely Manufactured in Italy

## DESCRIPTION

The FBT VERTUS CLA 118SA processed active subwoofer is the perfect low-frequency extension and reinforcement for the FBT VERTUS CLA 406A array. The FBT VERTUS CLA 118SA meets the following performance criteria: frequency response from 33Hz to 120Hz, maximum SPL of 138dB, and a Class D 1200W RMS amplifier with a switch-mode power supply. It features 1 x 18" B&C high-excursion woofer with a 3" voice coil. The FBT VERTUS CLA 118SA includes a DSP processor with 8 available presets. The cabinet is constructed from 0.59" birch plywood, coated with a textured black finish, and the front is protected by a heavy-duty metal grille. The control panel provides XLR input and link, Volume control, Preset selection, Delay, 0°-180° phase switch, three status LEDs, and Neutrik PowerCon Cable Duplex connectors for power supply.

## TECHNICAL SPECIFICATIONS

### GENERAL

Code		39681
Configuration	way	Bass reflex
Low frequency woofer	inch	18 - 3 coil
High frequency driver	inch	---

### ACOUSTIC SPECIFICATIONS

Frequency response (@-6dB)	Hz	33 - 120
Sensitivity (@1W/1m)	dB	---
MAX SPL (cont/peak)	dB	134 / 138 half-space
Dispersion	H° x V°	Omnidirectional
Crossover frequency		Preset dependant

### INPUTS & OUTPUTS

Input connectors		XLR with loop
------------------	--	---------------

### POWER SUPPLY

AC power requirement	VA	640
----------------------	----	-----

### AMPLIFIER

Built-in amplifier max	W RMS	1200
Built-in amplifier peak	W RMS	2400
Input impedance	Ohm	22k

### MECHANICAL SPECIFICATIONS

Material	Cabinet	0.59" Birch plywood
	Grille	Metal
Net dimensions (WxHxD)	mm	555 x 572 x 660
	inch	21.85 x 22.51 x 25.98
Transport dimensions (WxHxD) with pallet	mm	800 x 790 x 600
	inch	31.50 x 31.10 x 23.62
Net weight	kg	41.50
	lb	91.49
Transport weight with pallet	kg	48.50
	lb	106.92



## DIMENSIONAL DRAWING

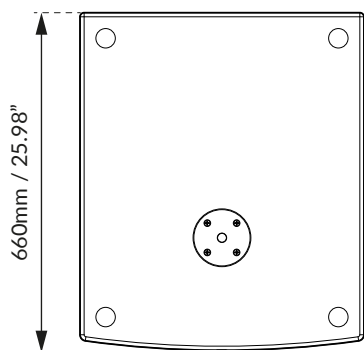
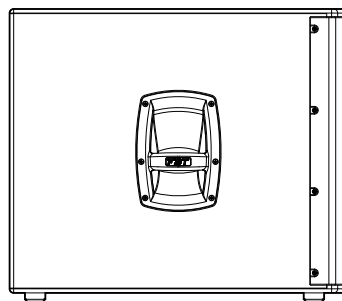
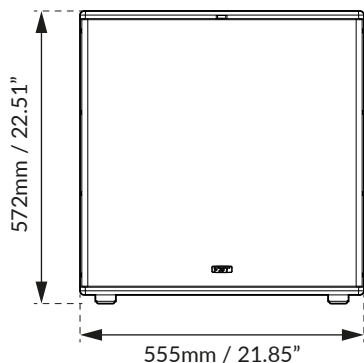

## ACCESSORIES

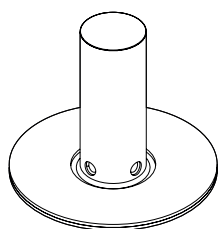

### VT-S0 406

**Speaker Stand h06**  
Code: 39904

ø110 x 93mm  
ø4.33 x 3.66inch  
0.50 kg / 1.10 lb

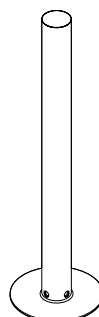

### VT-S30 406

**Speaker Stand h30**  
Code: 39903

ø110 x 400mm  
ø4.33 x 15.74inch  
1 kg / 2.20 lb

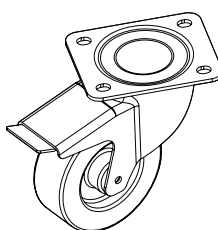

### KBM-1004S

**4 Wheels Kit with Brake**  
Code: 25197

ø100mm  
ø4inch  
4 kg / 8.81 lb