

Active Column Line Array

MAIN FEATURES

- 2 way bi-amplified line array column
- 0,47" birch plywood with scratch resistant varnish
- 4 x 6,5" custom woofer with 1,5" voice coil
- Neodymium B&C compression HF driver with 1,4" throat and 2,5" voice coil
- Class D 600W RMS amplifier for LF and 300W RMS for HF
- DSP processor with 8 equalization presets
- 100°H x 25°V dispersion
- Ideal for both live applications, assisted by the CLA118SA active subwoofer, as well as for fixed installation
- Completely Manufactured in Italy



DESCRIPTION

The FBT VERTUS CLA 406.2A two-way bi-amplified speaker system incorporates 4 x 6.5" custom woofers with 1.5" voice coils and 1 x 1.4" B&C HF neodymium driver with a 2.5" voice coil. The internal Class D amplifier module, constructed in die-cast aluminum, delivers 600W for LF, 300W for HF, and a DSP processor with 8 equalization presets, providing unexpected dynamics in a system of these dimensions. The FBT VERTUS CLA 406.2A shall meet the following performance criteria: frequency response from 65Hz to 20kHz, maximum SPL of 133dB, horizontal coverage angle of 100°, and vertical coverage angle of 25°. The FBT VERTUS CLA 406.2A features a 0.47" birch plywood construction with internal metal bracing, and the front is protected by a heavy-duty metal grille. The control panel provides Level control, HF level, Preset, HP filter, Gnd lift, 3 status LEDs (on, peak, prt/limit), XLR input & link, and Neutrik Powercon Cable Duplex for power supply. With new hardware, it is possible to couple two or more CLA 406.2A/CLA 206A units at an angle of 0°-20° in 5° steps vertically, and additional accessories are available for system suspension. Four lateral inserts (two upper and two lower) are designed to accept quick-release pins or M10 screws. It can be elegantly integrated into any environment with minimal intrusion, making it ideal for live applications when paired with the CLA 118SA subwoofer, as well as for fixed installations.

TECHNICAL SPECIFICATIONS

GENERAL

| | | |
|-----------------------|------|--------------------|
| Code | | 41791 |
| Configuration | way | 2 bi-amplified |
| Low frequency woofer | inch | 4 x 6.5 - 1.5 coil |
| High frequency driver | inch | 1.4 - 2.5 coil |

ACOUSTIC SPECIFICATIONS

| | | |
|----------------------------|---------|----------|
| Frequency response (@-6dB) | Hz | 65 - 20k |
| Sensitivity (@1W/1m) | dB | --- |
| MAX SPL (cont/peak) | dB | 133 |
| Dispersion | H° x V° | 100 x 25 |
| Crossover frequency | Hz | 1.2k |

INPUTS & OUTPUTS

| | | |
|------------------|--|---------------|
| Input connectors | | XLR with loop |
|------------------|--|---------------|

POWER SUPPLY

| | | |
|----------------------|----|------|
| AC power requirement | W | 640 |
| Power cord | mt | 5 |
| | ft | 16.4 |

AMPLIFIER

| | | |
|------------------------------|-------|------------|
| Built-in amplifier LF/HF max | W RMS | 600 / 300 |
| Buit-in amplifier max peak | W | 1200 / 600 |
| Input impedance | Ohm | 22k |

MECHANICAL SPECIFICATIONS

| | | |
|------------------------------|---------|-----------------------|
| Material | Cabinet | 0.47" Birch plywood |
| | Grille | Metal |
| Net dimensions (WxHxD) | mm | 190 x 1140 x 290 |
| | inch | 7.48 x 44.88 x 11.41 |
| Transport dimensions (WxHxD) | mm | 320 x 1265 x 445 |
| | inch | 12.60 x 49.80 x 17.52 |
| Net weight | kg | 28 |
| | lb | 61.72 |
| Transport weight | kg | 31.50 |
| | lb | 69.44 |

DIMENSIONAL DRAWING

CONTROL PANEL

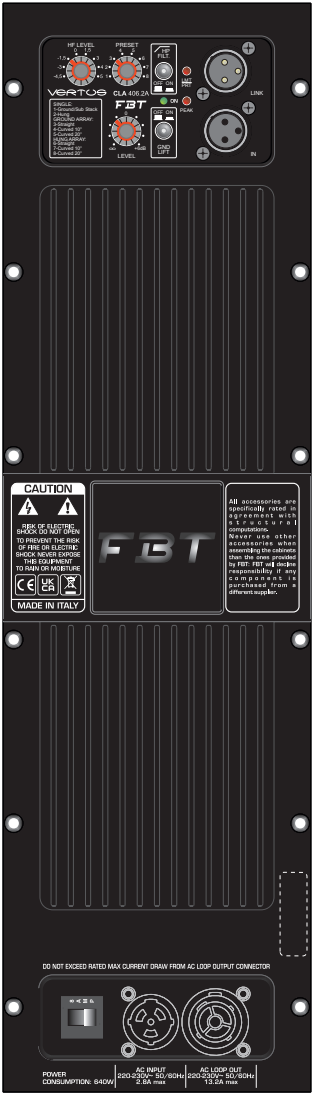
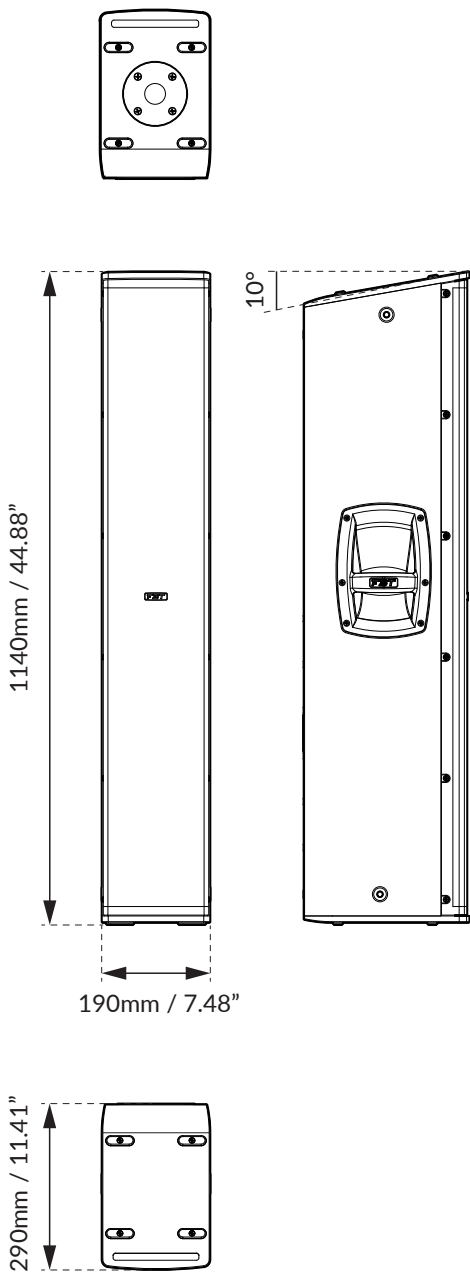

ACCESSORIES

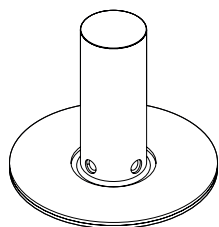

VT-S0 406

Speaker Stand h0
Code: 39904

ø110 x 93mm
ø4.33 x 3.66inch
0.50 kg / 1.10 lb

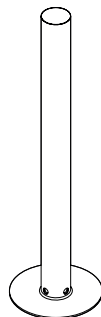

VT-S30 406

Speaker Stand h30
Code: 39903

ø110 x 400mm
ø4.33 x 15.74inch
1 kg / 2.20 lb

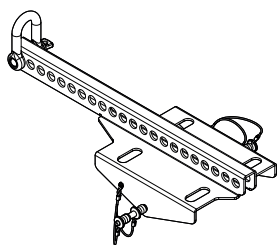

VT-F 406.2

Flying Bar
Code: 41803

565 x 117 x 200mm
22.24 x 4.63 x 7.87inch
4.50 kg / 9.92 lb

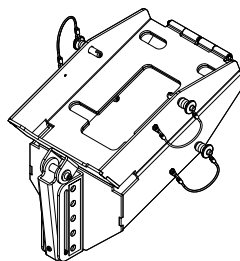

VT-J 406.2

Joint Bar
Code: 41802

398 x 216 x 200mm
15.66 x 7.87 x 7.87inch
7 kg / 15.43

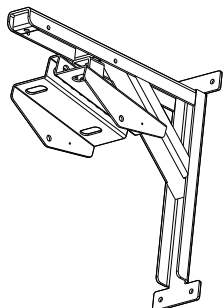

VT-W 406.2

Wall Mount
Code: 44797

512 x 490 x 122mm
20.17 x 19.29 x 4.82inch
9 kg / 19.84 lb

⚠ IMPORTANT | Use all holes for wall mounting

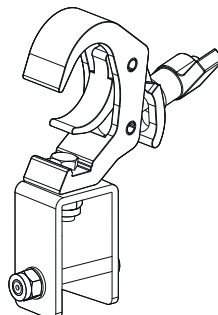

VT-T 406

Clamp
Code: 41805

152 x 190 x 75mm
5.98 x 7.48 x 2.95inch
0.70 kg / 0.9 lb