

Column Line Array

EN 54-24:2008

 EN 54-16:2008 / IP55
 Cert. Nr. 0068-CPR-142/2020

IP55

 Declaration of Performance (DoP)
 available on the website: www.fbt.it

MAIN FEATURES

- Extruded aluminum cabinet
- 8 x 3" fullrange driver with 0.75" voice coil
- 70V/100V transformer
- Cerminal terminal block in & through wire connection
- EN 54-24 Certificate of Conformity / IP55
- Completely manufactured in Italy

DESCRIPTION

Suited to both indoor and outdoor use, the VERTUS CLA 803T features eight 3" full-range woofers. The VERTUS CLA 803T offers powerful new features for systems integrators facing challenging acoustic conditions. The column features an extruded aluminum construction and is characterized by an integrated passive directivity control system, which delivers consistent frequency-based vertical dispersion. Users have the choice of two angles, NARROW and WIDE, offering respectively 110°H x 15°V and 110°H x 40°V. The VERTUS CLA 803T is fully modular and includes a 100V line transformer with switchable power levels, allowing multiple enclosures to be linked to increase low-frequency control, high-frequency dispersion, and overall SPL. The accessories match the enclosures with sliding guides and integrated quick-release pins for exceptionally quick, easy, and effective installation.

TECHNICAL SPECIFICATIONS

GENERAL

Code	Black	41806
	White	41823
Configuration	way	1
Fullrange driver	inch	8 x 3 - 0.75 coil

ACOUSTIC SPECIFICATIONS

Frequency response (@-6dB)	Hz	150 - 20k
Sensitivity (@1W/1m)	dB	94
MAX SPL (@1m/4m)	dB	112 / 100
HORIZONTAL dispersion (-6dB) NARROW = Wide setting		360° (500Hz)
		170° (1kHz)
		125° (2kHz)
		125° (4kHz)
		100° (8kHz)
VERTICAL dispersion (-6dB) WIDE setting		70° (500Hz)
		35° (1kHz)
		26° (2kHz)
		26° (4kHz)
		20° (8kHz)
VERTICAL dispersion (-6dB) NARROW setting		70° (500Hz)
		35° (1kHz)
		18° (2kHz)
		10° (4kHz)
		10° (8kHz)

INPUTS & OUTPUTS

Input connectors		Cerminal terminal block
------------------	--	-------------------------

AMPLIFIER

Recommended amplifier	W RMS	200
Rated noise power (100hrs)	W (V)	100 (28.2)
Nominal impedance	Ohm	8
Nominal impedance 100V line	Ohm (W)	100 (100) / 200 (50)

MECHANICAL SPECIFICATIONS

Operating / Storage temperature	°C	-25 ÷ +55 / -40 ÷ +70
Relative Humidity		<95%
Material	Cabinet	Aluminium
	Grille	Perforated powdercoated steel
Net dimensions (WxHxD)	mm	100 x 704 x 125
	inch	3.93 x 27.69 x 4.92
Transport dimensions (WxHxD)	mm	190 x 760 x 170
	inch	7.48 x 29.92 x 6.69
Net weight	kg	5.50
	lb	12.12
Transport weight	kg	6.20
	lb	13.66

DIMENSIONAL DRAWING

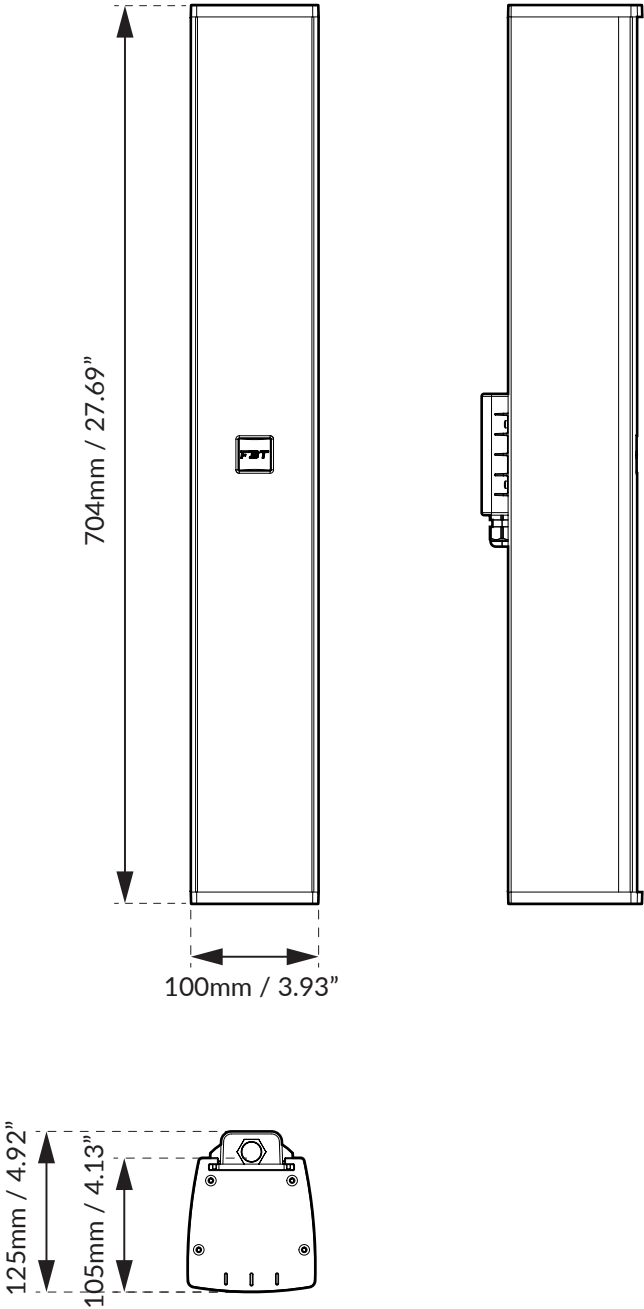

CONNECTION PANEL

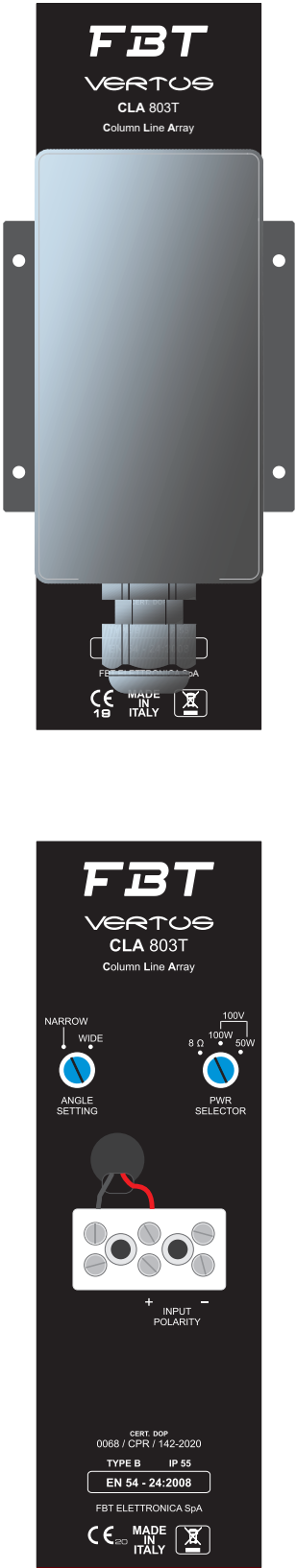

ACCESSORIES

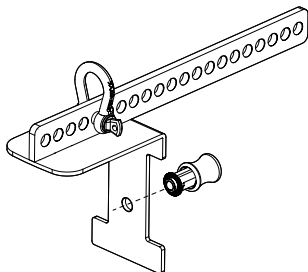

VT-F 3

Flying Bar

Black code: 41795

White code: 41820

260 x 130 x 65mm
10.23 x 5.11 x 2.55inch
0.53 kg / 1.16 lb

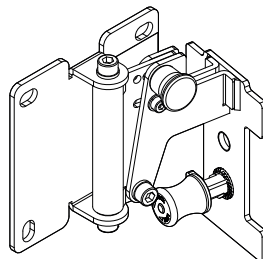

VT-W 3

Vertical Wall Mount

Black code: 41797

White code: 41821

AISI 316L - stainless steel

100 x 100 x 90mm
3.93 x 3.93 x 3.56inch
0.68 kg / 1.49 lb

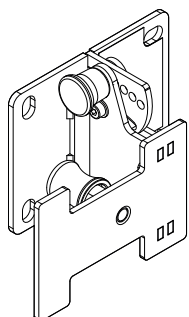

VT-WH 3

Horizontal Wall Mount

Black code: 41798

White code: 41822

AISI 316L - stainless steel

105 x 88 x 51mm
4.13 x 3.46 x 2inch
0.53 kg / 1.16 lb

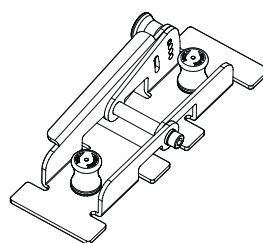

VT-J 3

Joint Bar 0°-15°

Black code: 41794

White code: 41819

AISI 316L - stainless steel

197 x 56 x 75mm
7.77 x 2.22 x 2.95inch
0.57 kg / 1.25 lb

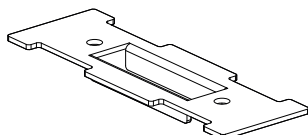

VT-JF 3

Joint Bar

Black code: 41799

White code: 42955

197 x 15 x 65mm
7.75 x 0.59 x 2.55inch
0.32 kg / 0.70 lb

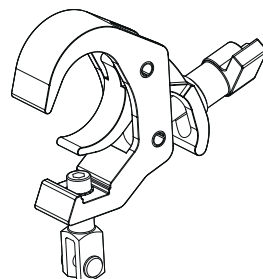

VT-T 3

Clamp for Attachment to Trellis

Code: 41796

152 x 151 x 62mm
5.98 x 5.94 x 2.44inch
0.50 kg / 1.10 lb