

Passive Column Line Array

MAIN FEATURES

- 2-way reflex line array
- 4 x 6.5" custom woofer with 1.5" voice coil
- 1.4" neodymium B&C compression HF driver with 2.5" voice coil
- Recommended amplifier: 800W RMS / 8Ohm
- Frequency response: 65Hz to 20kHz
- MAX SPL: 134dB
- Dispersion: 100°H x 25°V (dependant upon n° of element)
- 2 x Neutrik NL4M Speakon connectors In & link
- 0.47" Birch plywood cabinet with scratch-resistant varnish
- Two diecast aluminium carrying handles
- 1.37" stand socket and 4 lateral insert point
- Top side inclined by 10°
- The system can be used in point source system with the CLA 118S and in vertical cluster with the CLA 206 down-fill



DESCRIPTION

The VERTUS CLA 406.2 is a passive column line array in 2-way reflex, featuring a 4 x 6.5" custom woofer with a 1.5" voice coil and 1.4" neodymium B&C compression HF driver with a 2.5" voice coil. VERTUS CLA 406.2 meet the following performance criteria: recommended amplifier power of 800W RMS / 8Ohm, capable of achieving 134dB SPL, horizontal coverage angle of 100° and vertical coverage angle of 25°. The bass-reflex line array cabinet offers a frequency response from 65Hz to 20kHz and can extend and reinforce low frequencies when paired with a ground-stack configuration using the VERTUS CLA 118S. There is a passive crossover internal; an external processor with FBT presets is required. Using external DSP presets allows for creating various configurations. VERTUS CLA 406.2 is a 0.47" birch plywood cabinet with scratch-resistant varnish, internal metal bracing and a scratch-resistant coating for stackability. The front is protected by a heavy-duty metal grille, two side handles and a rubber insert for protection and upper/lower anti-slip. The rear-facing input panel provides two Neutrik NL4M Speakon connectors In & link, and the bottom of the cabinet is equipped with an 1.37" speaker stand socket. The accessories available are a flybar for hanging the system (max 3 CLA 406.2), to which it is possible to add a clamp for tubular hooking, a foldable floor support with 0° and -10° angle, a mechanical joint for coupling two speakers with 0°-20° angle in steps of 5°. Four lateral inserts (two upper and two lower) are designed to accept quick-release pins or M10 screws.

TECHNICAL SPECIFICATIONS

GENERAL

Code		46252
Configuration	way	2 reflex
Low frequency woofer	inch	4 x 6.5 - 1.5 coil
High frequency driver	inch	1.4 - 2.5 coil

ACOUSTIC SPECIFICATIONS

Frequency response (@-6dB)	Hz	65 - 20k
Sensitivity (@1W/1m)	dB	---
MAX SPL (cont/peak)	dB	129 / 134
Dispersion	H° x V°	100 x 25 - Dependent upon n° of element
Recommended HP filter	Hz - dB oct	60 - 24
Recommended Ext. filter		Authorized FBT preset for digital processor or processed amplifier

INPUTS & OUTPUTS

Input connectors		2 x Speakon NL4M In & link
------------------	--	----------------------------

AMPLIFIER

Recommended amplifier	W RMS	800
Long term power	W	400
Short term power (IEC 268-5)	W	1600
Nominal impedance	Ohm	8

MECHANICAL SPECIFICATIONS

Material	Cabinet	0.47" Birch plywood
	Grille	Metal
Net dimensions (WxHxD)	mm	190 x 1140 x 290
	inch	7.48 x 44.88 x 11.41
Transport dimensions (WxHxD)	mm	320 x 1265 x 445
	inch	12.60 x 49.80 x 17.52
Net weight	kg	26.1
	lb	57.54
Transport weight	kg	29.2
	lb	64.37

DIMENSIONAL DRAWING

CONTROL PANEL

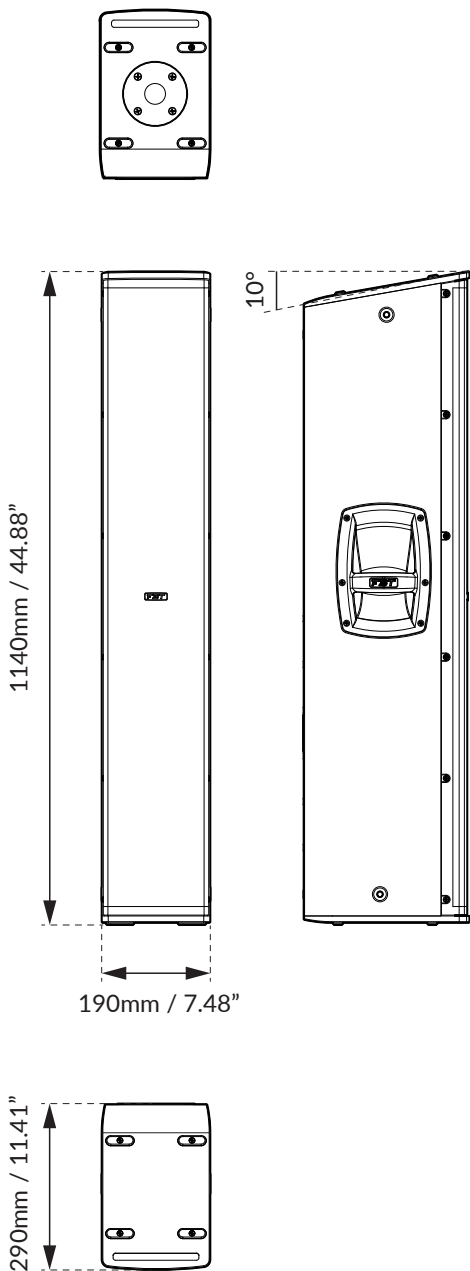

FBT

VERTUS

CLA 406.2

INPUT

OUTPUT

LF

HF

HP

TECHNICAL SPECIFICATIONS

NOMINAL IMPEDANCE 8 Ω

RECOMMENDED AMPLIFIER 800 W RMS

LONG TERM POWER 400 W

IT IS IMPORTANT TO USE ANY AMPLIFIER THAT DOES NOT EXCEED 800 WMS S & D

ATTENTION:

ALL ACCESSORIES ARE SPECIFICALLY RATED IN AGREEMENT WITH STRUCTURAL COMPUTATIONS. NEVER USE OTHER ACCESSORIES. WHEN ASSEMBLING THE CABINETS THAN THE ONES PROVIDED BY FBT, FBT WILL DECLINE RESPONSIBILITY OVER THE ENTIRE ACCESSORIES RANGE IF ANY COMPONENT IS PURCHASED FROM A DIFFERENT SUPPLIER.

CE UK CA

MADE IN ITALY

FBT ELETTRONICA SpA - Recanati (MC)

ACCESSORIES

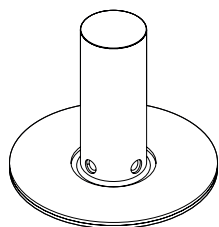

VT-S0 406

Speaker Stand h0
Code: 39904

ø110 x 93mm
ø4.33 x 3.66inch
0.50 kg / 1.10 lb

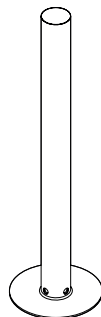

VT-S30 406

Speaker Stand h30
Code: 39903

ø110 x 400mm
ø4.33 x 15.74inch
1 kg / 2.20 lb

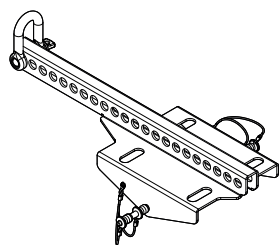

VT-F 406.2

Flying Bar
Code: 41803

565 x 117 x 200mm
22.24 x 4.63 x 7.87inch
4.50 kg / 9.92 lb

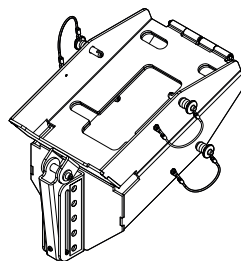

VT-J 406.2

Joint Bar
Code: 41802

398 x 216 x 200mm
15.66 x 7.87 x 7.87inch
7 kg / 15.43

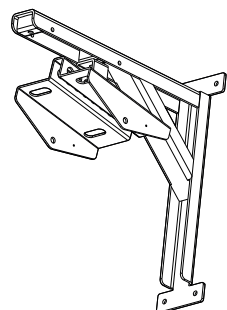

VT-W 406.2

Wall Mount
Code: 44797

512 x 490 x 122mm
20.17 x 19.29 x 4.82inch
9 kg / 19.84 lb

⚠ IMPORTANT | Use all holes for wall mounting

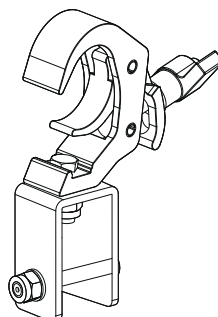

VT-T 406

Clamp
Code: 41805

152 x 190 x 75mm
5.98 x 7.48 x 2.95inch
0.70 kg / 0.9 lb