

Network Control & Dante Networked

Revision 01 - #16 June 2025

FBT TALOS amplifiers are set up with MYRA presets at FBT factory. Assigned presets are:

- **AMP 1 (TOP):** CH 1 & 2 are MYRA 218S, CH 3 & 4 are MYRA 214L LOW & MidHigh.
- **AMP 2 (CENTER):** CH 1 & 2 are MYRA 218S, CH 3 & 4 are MYRA 214L LOW & MidHigh.
- **AMP 3 (BOTTOM):** CH 1 & 2 are MYRA 214L LOW & MidHigh, CH 3 & 4 are MYRA 214L LOW & MidHigh.

Mix SUB and TOP on the same amplifier is good to balance the power supply energy requirement and improve output peak power.

There are three presets available on the MYRA LIBRARY for SE8.1:

1. **MYRA214L:** use with MYRA214L line array; uses two amplifier channels (LOW and MID/HI), optimized for a cluster of 8 MYRA 214L.
2. **MYRA218S:** use with MYRA 218S subwoofer in standard mode.
3. **MYRA218S cardio:** use with MYRA 218S subwoofer for CARDIOID configuration (must be assigned to the reversed subwoofer).

Install **SYSTEM ENGINEER 8.1** to a windows PC, connect MYRACK with an Ethernet cable to monitor and control amplifiers. Software, MYRA LIBRARY and compatible TALOS amplifier firmware are available at <https://www.fbt.it/en/products/noline/myrack/4eccb3bd-3cbf-40c6-bd63-063ec85f9c12>. Make sure that TALOS use updated firmware.

PRESET settings (crossover, EQ's, limiters) vital to ensure proper system performance and safety are hidden at factory.

To import the LIBRARY file, in SETUP mode, click on **import library** [].

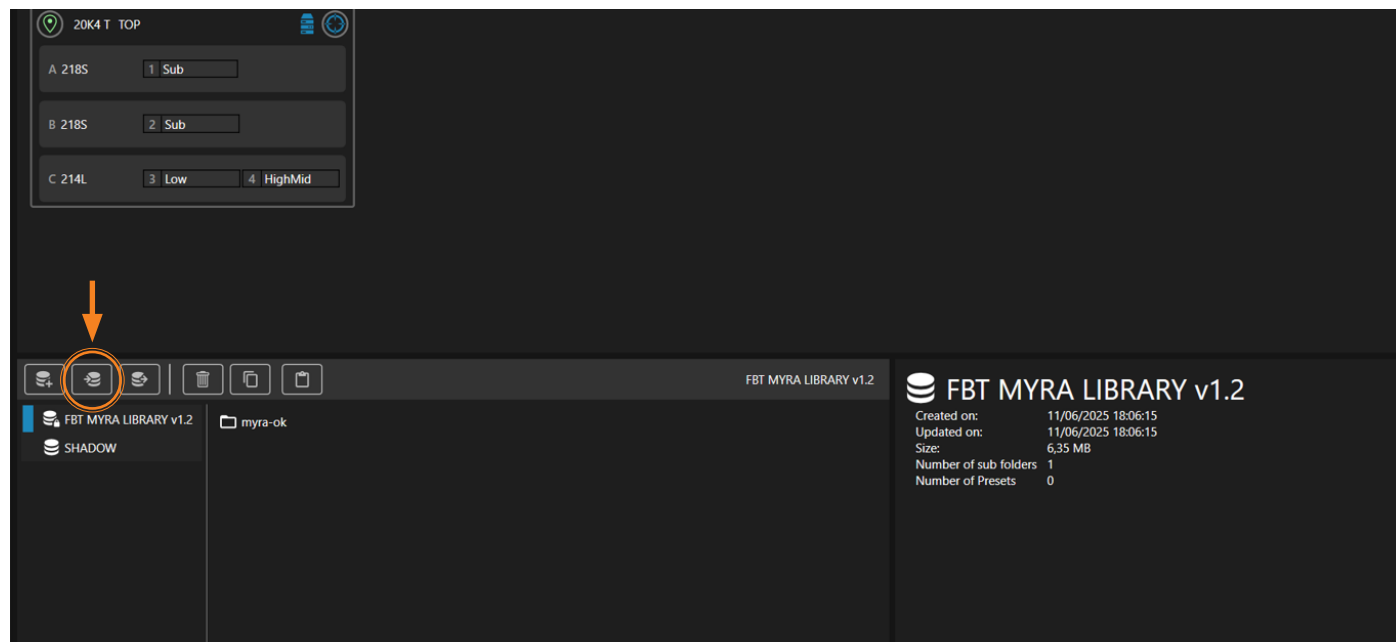

Locate and select from PC folder the file “FBT MYRA LIBRARY vX.X.lpr”.

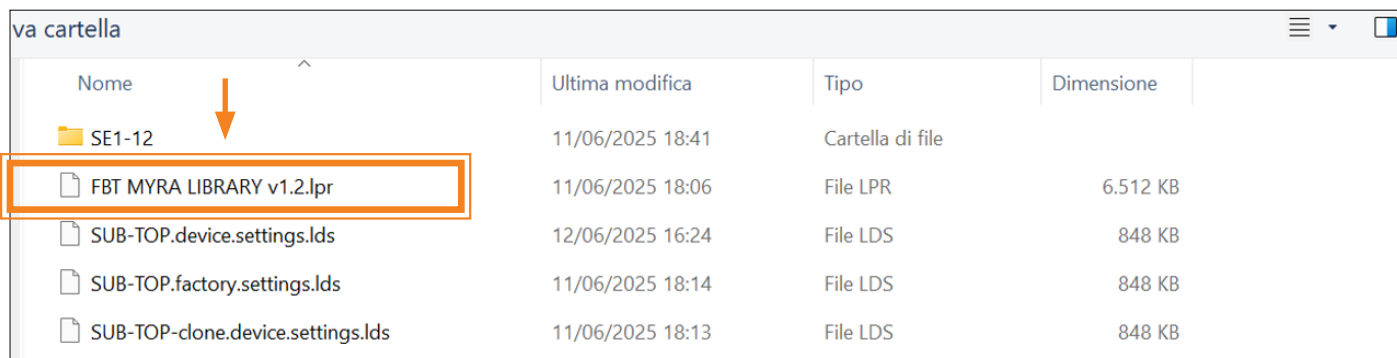

Once loaded, select the folder “MYRA-OK” and the three presets (locked) will appear. The presets remain on the SYSTEM ENGINEER memory even if the application will be closed.

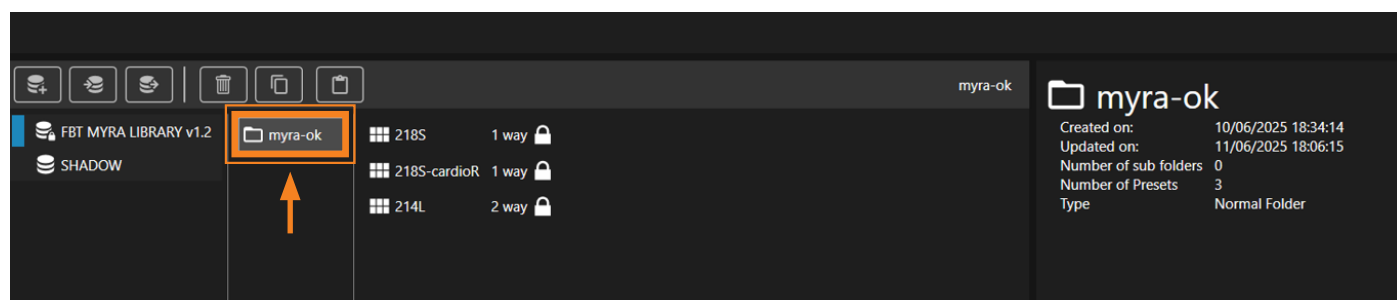

To assign a preset to a DSP channel of the TALOS amplifier, select first the DSP channel (A,B or C) and assignable presets will be highlighted. Then select the preset and click on ‘LOAD TO SELECTED MODULES’. On the example, 218S preset is assigned to DSP B.

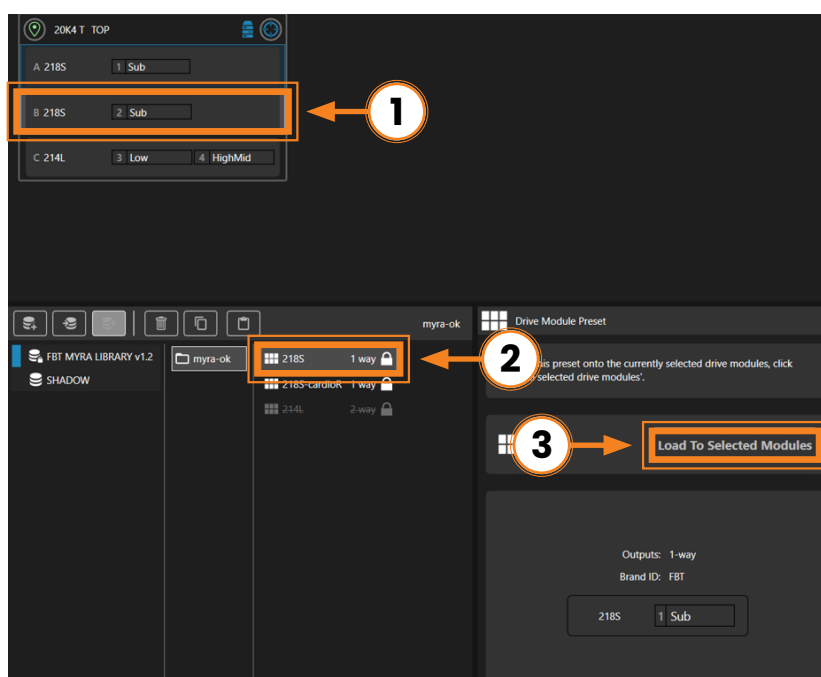

On this example, 214L preset is assigned to DSP C that is configured as a two-way. In this case only compatible presets (two way) can be assigned.

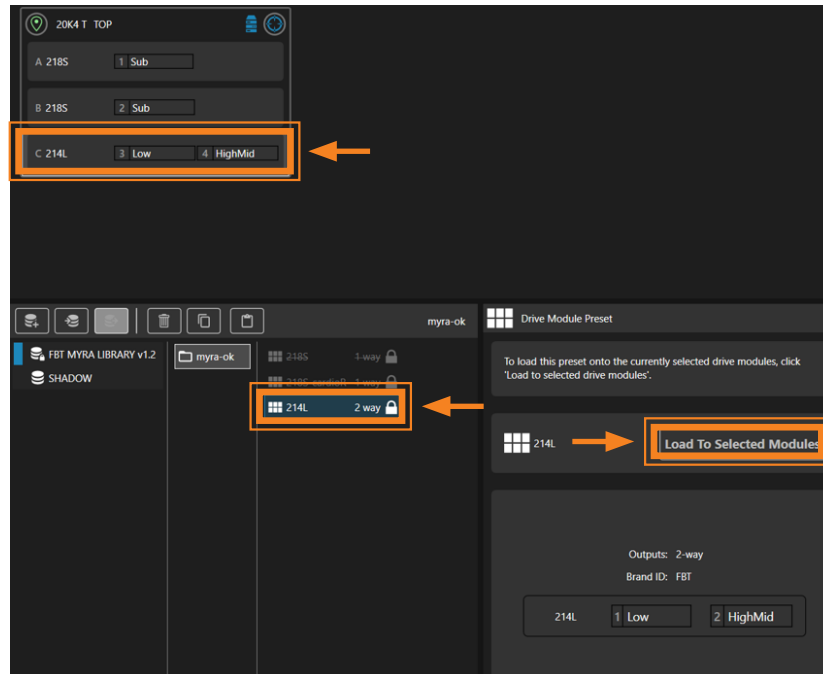

OUTPUT MATRIX setting is very important because it decides the number of ways assigned to a DSP channel and therefore the preset compatibility. The figure show the correct setting for AMP 1 where CH 1 & CH2 are assigned respectively to DSP A and DSP B and drive MYRA 218S SUB (one way preset 218S assigned). CH 3 & 4 are assigned both to DSP C and drive MYRA 214L (two way preset 214L assigned).



The following case show the correct setting for AMP 3 where CH 1 & 2 are assigned DSP A and CH 3 & 4 are assigned both to DSP C. Both DSP became compatible only with two way presets and drive MYRA 214L (two way preset 214L assigned).

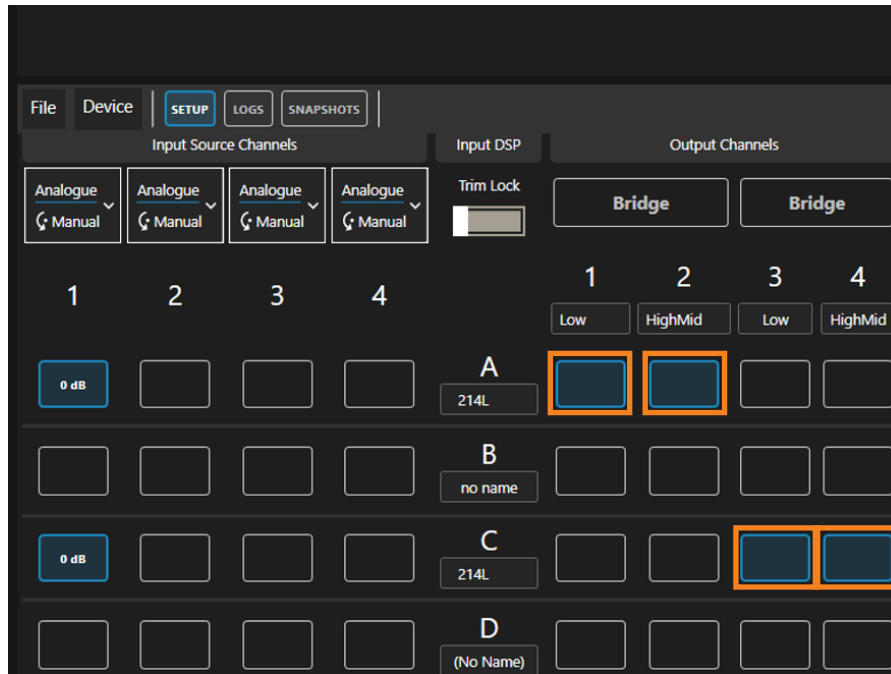

Warning

⚠ At this moment OUT MATRIX is always free (not possible to lock once the DSP is associated with a preset), so the OUT channels assignment can be changed manually. This is no good because wrong setting in the OUT channel routing to DSP can results in driver failure and poor sound. We are working with LINEA RESEARCH to lock this section once the preset is assigned, this will be made on future SE 8 releases.

⚠ OUT MATRIX routing is associated with the PRESET! Changing OUTPUT channels routing to DSP channels manually (possible with SE8.1 software) results in malfunction of the system and possible damage to the transducers!

⚠ Changing PRESET assignments can change OUTPUT routing to speaker connection panel. Before connecting speakers, double check OUTPUT preset amplifier assignment matches wiring. Be sure to connect MYRA214L to amplifier outputs (LOW and MID/HI) associated with MYRA214L preset. Similarly, ensure MYRA218S is connected to amplifier channel with MYRA218S preset.

⚠ **Never use MYRA SYSTEM without official FBT presets! This will result in poor system performance and damage transducers! After connecting speaker cables, make a test with very low volume PINK noise and check correct cable routing and preset assignment. Connecting MYRA214L to an OUTPUT assigned to MYRA218S/cardio PRESET will DAMAGE transducers in a few seconds!**

DANTE audio option

MYRACK is available with or without DANTE networked audio capability.

Retrofit of DANTE CARD on TALOS amplifiers is possible to enable DANTE networked audio capability. The operation must be done at FBT or at authorized service center, it is not possible to upgrade directly from customers. Please ask FBT about availability and price of DANTE card UPGRADE.

More information on Dante networked audio with associated software can be found at <https://www.audinate.com/>.